

Winona Shelf Bracket

Winona Support d'étagère

Winona Soporte de estante

WARNING: This product can expose you to chemicals including Lead which is known to the State of California to cause cancer and birth defects or other reproductive harm. For more information go to <https://www.p65warnings.ca.gov/>

PARTS INCLUDED

- 2pcs Shelf Brackets
- 4pcs #8-1" countersunk bracket mounting screws
- 2pcs #8-3/4" small wood screws
- 4pcs Drywall anchors

TOOLS REQUIRED: Slotted Screwdriver, Phillips Screwdriver, Pencil, Tape measure, Level,

The maximum loading is 65 lbs (29.5 kgs).

MOUNTING INSTRUCTIONS FOR TYPICAL DRYWALL APPLICATIONS

Note: Consult your local hardware store for proper mounting to other wall materials.

1. Place one bracket in desired location. Mark the location of drywall anchor installation.
2. Use Phillips screwdriver to insert the anchors as it is designed to bore into the wall like a screw. Do not push or pound. Turn clockwise until anchor is flush with the wall.
3. Once all anchors are in place, place the bracket over anchor and insert mounting screws. Do not overtighten.
4. Determine the location for the second bracket and mark the location of anchor installation. Use a level to ensure the brackets are level. Then, repeat steps 2 & 3 for the second bracket.
5. Small wood screws are inserted into the predrilled holes at the top of the brackets to secure the shelf.

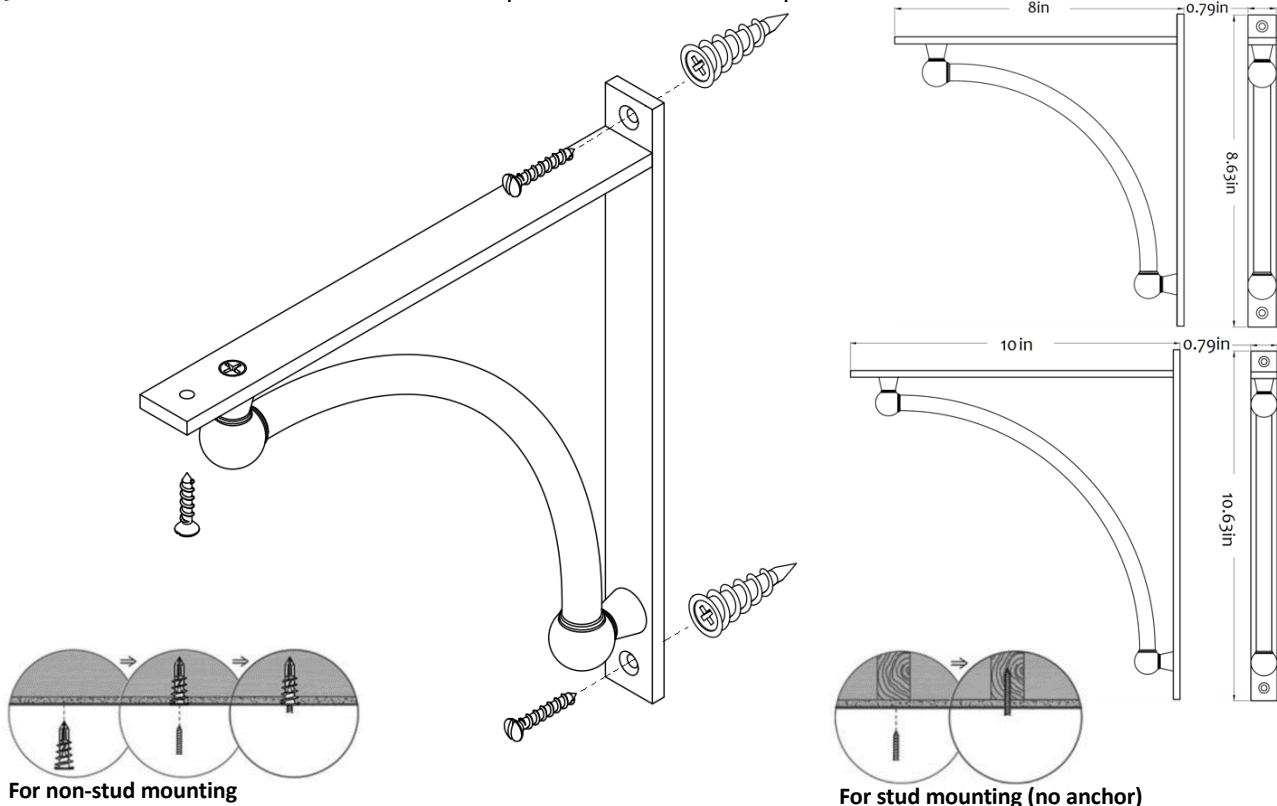

For non-stud mounting

Tips:

The anchor is self-drillable. No pilot hole required.

For stud mounting (no anchor)

CARE INSTRUCTIONS

- Dust often using a clean, soft, dry and lint-free cloth.
- We do not recommend the use of chemical cleansers, abrasives or furniture polish on our lacquered finish.
- Hardware may loosen over time. Periodically check to make sure all connections are tight. Re-tighten if necessary.