

REJUVENATION

www.rejuvenation.com

LENNON WALL-MOUNT POWDER SINK

Specifications:

Installation:	Wall-mount, vanity-top, or self rimming
Exterior Dimensions:	23 5/8" w x 13 3/4" d x 5 1/2" h
Material:	Porcelain
Weight:	24 lbs
Overflow:	Yes
Finishes:	White
Faucet Holes:	no hole one hole
Cutout Size:	20 1/2" x 12 1/2"
Faucet Hole Size:	Ø 1 3/8"
Drain Hole Size:	Ø 1 3/4"



Features:

- Porcelain sink with overflow
- Most standard American drains can also be used
- Unglazed back wall - it must be installed against a wall
- Location of wall-mount holes is approximate
- Wall-mounting bolts are included
- Glazed bottom
- Current cut-out template can be requested

Codes + Standards:

- Meets and exceeds applicable national codes and standards

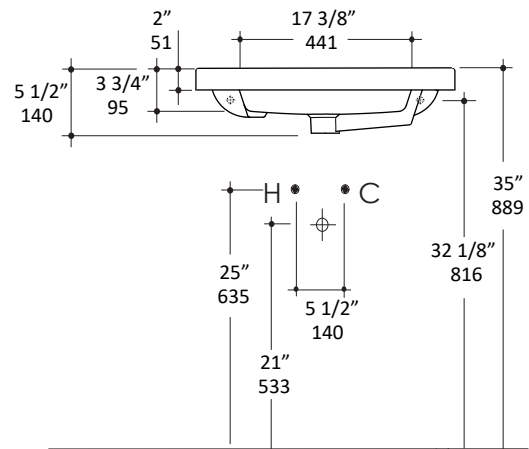
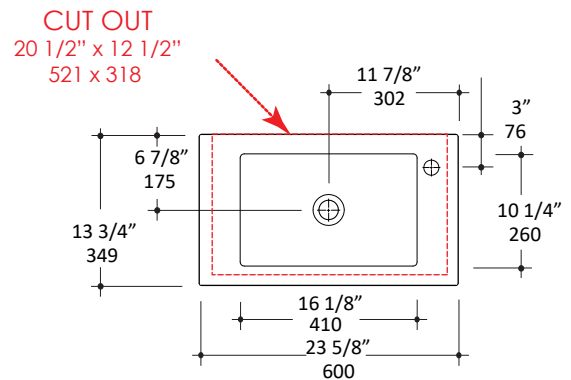

±. Dimensions are nominal and may vary within an industry accepted tolerance of 1/4".

Drawings provided herein are meant to give the user an idea of the product and are not made to scale.

Revised: 7/15/2019

Installation Instructions for Wall-mount Sinks



1. In order to provide proper support for wall-mounting a sink, it's usually necessary to remove a small section of drywall so that the wall studs can be accessed to attach blocking between them.
2. Based on the sink's dimensions and mounting height (usually 30"-35" above floor), decide where support will be needed.
3. Remove the drywall in that area and install 2-by-6 or 2-by-8 blocking between the wall studs. Then using 3 1/2" galvanized common nails, toenail the blocking to the studs and repair the drywall.
4. If the studs cannot be used then 3/4" plywood support behind the finished wall can also provide the necessary support.
5. Place the sink onto the desired position on the wall and mark the wall through the mounting holes on the sink. Then drill pilot holes for the mounting bolts, using a masonry bit if the wall is tiled.
6. Screw the wood threaded part of the mounting bolts into the pilot holes so that the machine threaded portion is sticking out of the wall.
7. Install the faucet and drain assemblies onto the sink based on their instructions.
8. Place the sink onto the mounting bolts against the wall, making sure that the sink is positioned properly and completely level.
9. From underneath the sink, place the plastic sleeves onto the mounting bolts first in order to protect the porcelain. Then slide on the metal washers followed by the locking nuts.
10. Tighten the nuts a little bit at the time, alternating between them, until the sink is secure against the wall. Please make sure not to crack the porcelain.
11. Apply a small bead of silicone around the sink back wall along the top and sides, and clean any excess following the instructions on the label.
12. Connect the P-trap and drain arm to the drain stub-out, and then connect the two water supply lines to the shut off valves. Some wall-mounted sinks come with a shroud piece that hides the plumbing. These would typically attach directly to the wall framing below the sinks with lag screws.