

REJUVENATION

Installation Instructions

2019.03.18

www.rejuvenation.com

INSTRUCTIONS FOR MODELS

Cross Handle

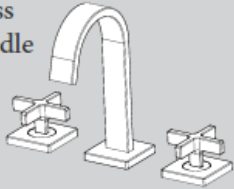

Lever Handle

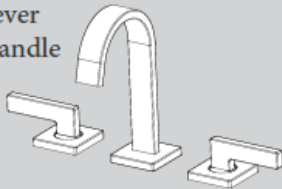

Blade Handle



NEED HELP?

For additional assistance or service please contact:

Rejuvenation

888-401-1900

customerservice@rejuvenation.com

www.Rejuvenation.com

TOOLS AND SUPPLIES



HELPFUL TOOLS & SUPPLIES:



IMPORTANT

- Do not over-tighten any connections or damage may occur.
- Be sure to read instructions thoroughly before beginning installation.
- This faucet has an operating range of 20-80 psi.

SAFETY TIPS

Cover your drain to prevent loss of parts. Be sure to wear eye protection while cutting pipe.

MAINTENANCE

Your new Rejuvenation Product is designed for years of trouble-free performance. Keep it looking new by cleaning it periodically with a soft cloth. The use of harsh chemicals and abrasives on any of the Rejuvenation custom finish products may damage the finish and void the product warranty. Please be sure to only use approved cleaners. Please contact Rejuvenation for any clarification of acceptable cleaners.

WARRANTY

Warranty information can be found at: www.Rejuvenation.com

1 Remove Inlet Hose Assembly (1), Mounting Nut (2), Metal Washer (3), and Rubber Washer (4) from Spout.

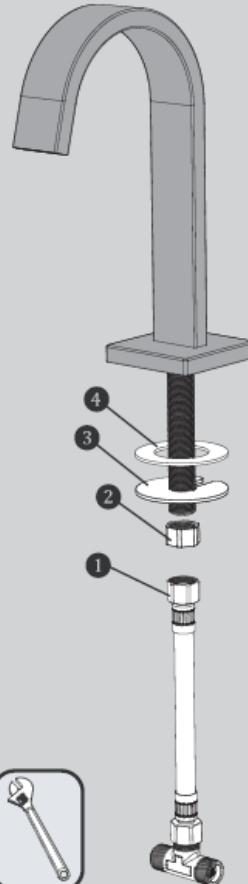

2 Remove Mounting Nut (1), Metal Washer (2), and Rubber Washer (3) from Cold Endbody Assembly. Repeat process for Hot Endbody Assembly

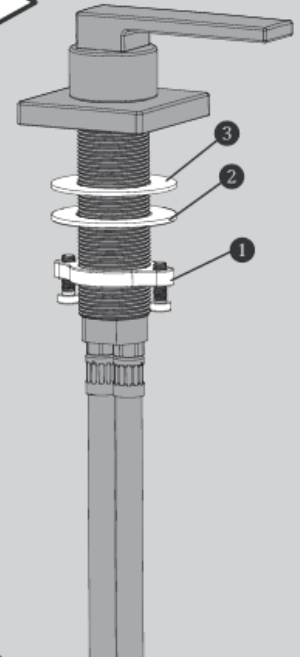

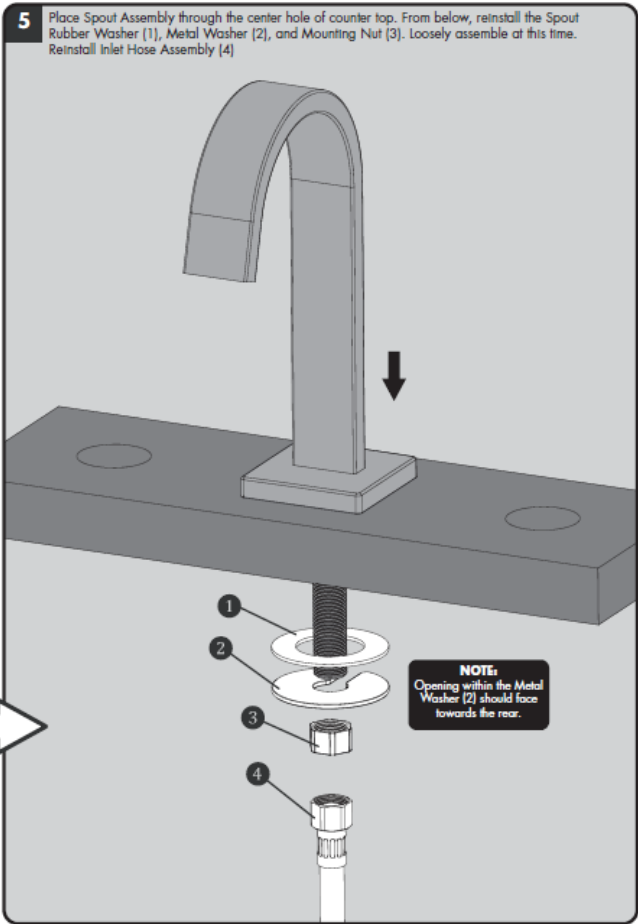
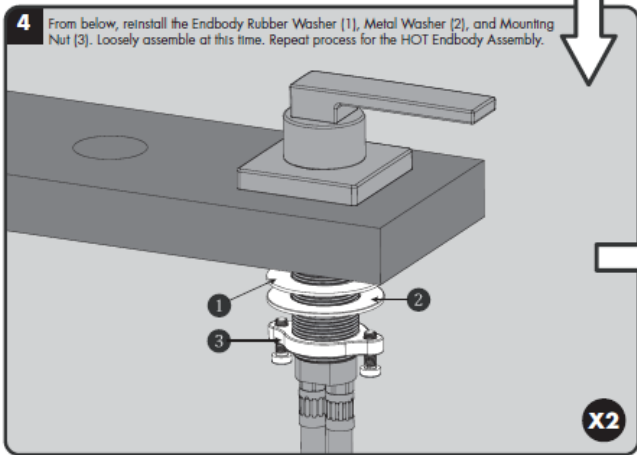
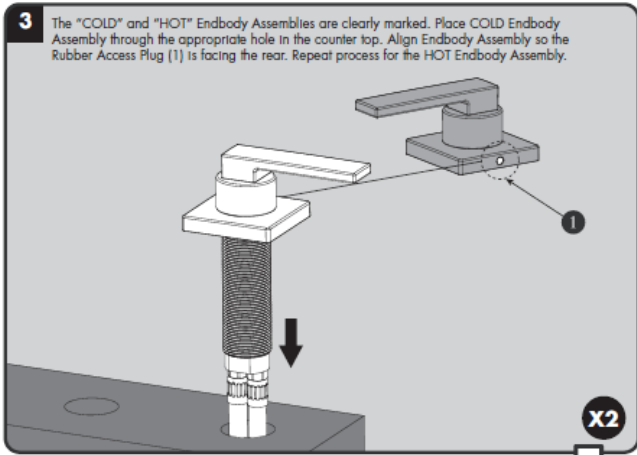

6 From above, align Spout and Handle bases so that they are aligned horizontally.

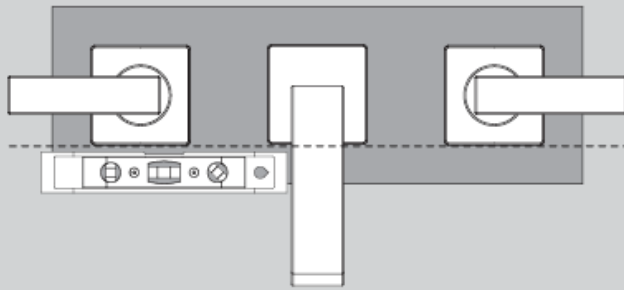

7 While maintaining the proper alignment, Wrench Tighten Spout Mounting Nut (1). Then snug Endbody Mounting Nuts (2). Final tightening of Endbody mounting is accomplished by Tightening the Mounting Screws (3) while using a Phillips Screwdriver. Wrench tighten Spout Inlet Hose (4).

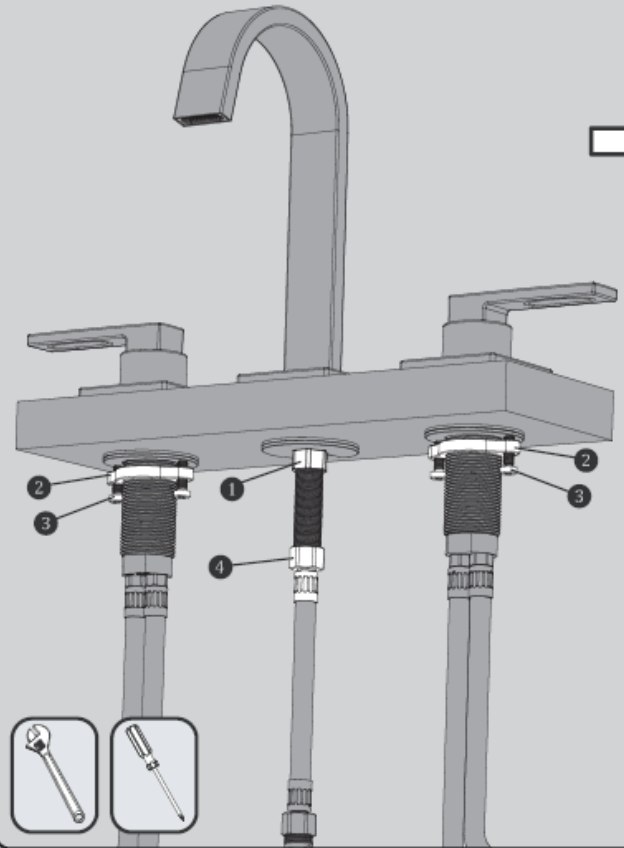

8 From below, install the Endbody Outlet Hoses (1) (shorter hose) to the Inlet Tee of the Spout (2). Wrench Tighten. Wrench tighten Spout Inlet Hose (3) to Inlet Tee (2).

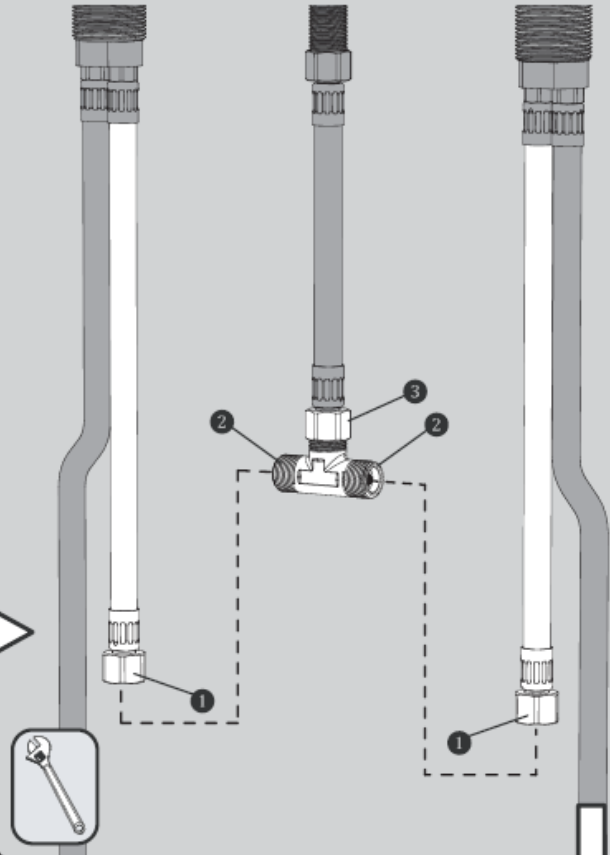

9 Make connections to water supplies. The Inlet threads of the faucet are 9/16"-24 UNEF and will accept a 3/8" Compression Fitting. Wrench Tighten.

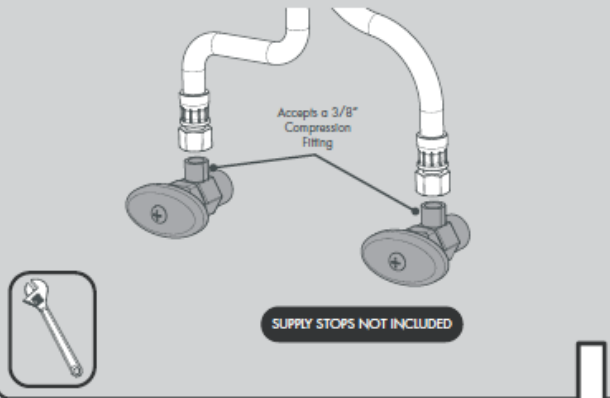

10 Turn on water supplies and flush both COLD and HOT cartridges for one minute, while checking for leaks. Return Handles to closed position when complete.

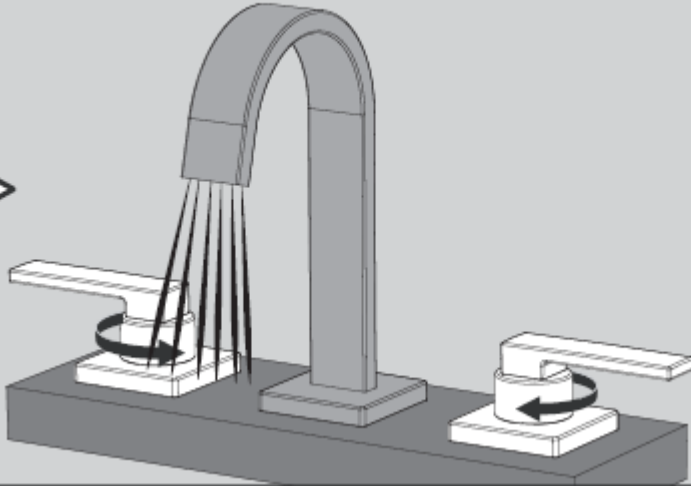

11 Align threaded hole of Aerator towards the rear as shown above. Install Aerator and secure into position using the included Hex Wrench.

