

Step 1/2

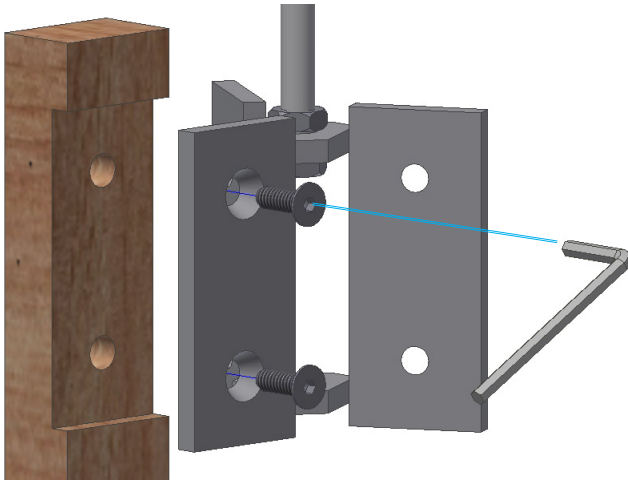

Step 5

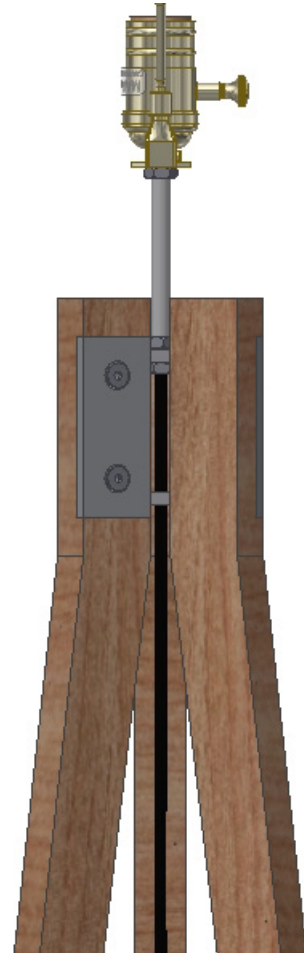

Step 3

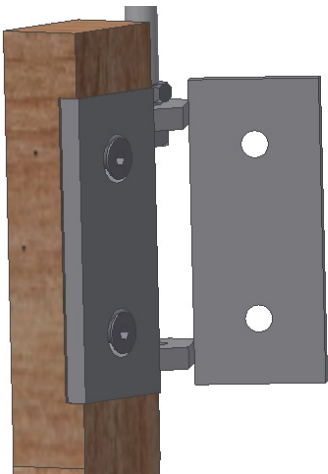

1. Align the flat plate of the three spoke hub assembly with the notch in one of the wooden tripod legs.
2. Thread the two hex socket cap screws through the plate into the threaded insert in the wood.
3. Install the screws until they are full seated, making sure that the plate sits flat in the notch.
4. Repeat step 1-3 with the second and third tripod legs until you have the lamp standing upright.
5. Once all six screws are in place and the plates are seated, tighten all six screws using the 5/32 hex key tool provided. Do not overtighten.
6. Felt rounds to protect floor and furniture finish are included.
7. The fixture should be cleaned with a damp cloth.