

SWAG HOOK SMALL OPEN LOOP

CROCHET DE BUTIN PETITE BOUCLE OUVERTE

BOTÍN GANCHO PEQUEÑO LAZO ABIERTO

Parts Included:

- (A) Swag Hook

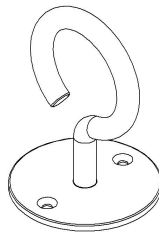

Hardware Included:

- (B) Screw – 2X



- (C) Wall Anchor – 2X

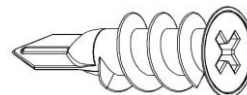

Tool Required (Not Included):

- (D) Phillips Head Screw Driver

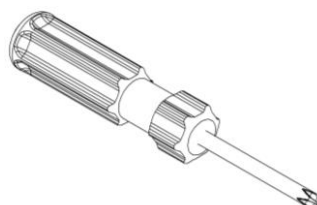

Step-1

Determine the desired location of the Swag Hook. Hold the Swag Hook (A) against the wall. Use a pencil to mark the wall through the Swag Hook holes as seen in the illustration below. These marks are the insertion points of the mounting hardware.

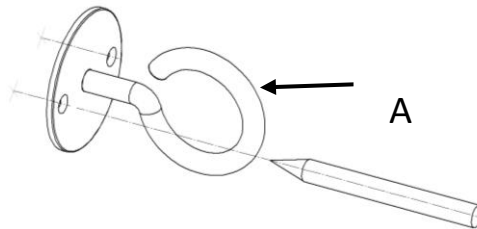

Step-2

To ensure proper installation of the wall anchor, align the pointed end of the Wall Anchor (C) against the marks from previous step. Use Philips Head Screwdriver (D) to rotate the Wall Anchor (C) clockwise as you push it lightly to the wall. The Wall Anchor (C) will self-drill and thread into the sheetrock as it is rotated. Continue rotating until the flange of the Wall Anchor (C) meets flush with the wall surface. Repeat this step for the rest of the Wall Anchor (C).

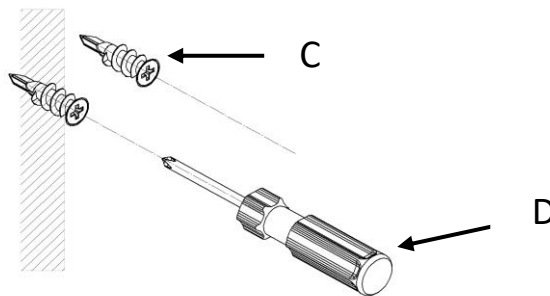

Step-3

Position the Swag Hook (A) against the wall and make sure that the holes are aligned with the installed Wall Anchor (C). Insert the Screws (B) using the Philips Head Screw Driver (D) through the holes of the Swag Hook (A) by rotating clockwise to tighten. Once screws are tight installation is complete.

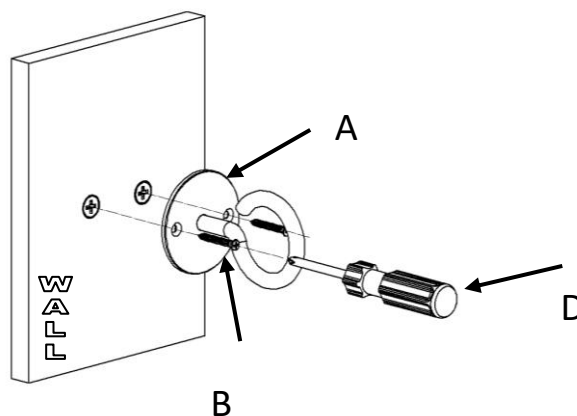

Step-4

Assembly is completed.