

Warehouse Fixtures - Scroll Support

skill level • basic electrician

installation instructions

• toolbox



Scroll Supports can be used above, below or both above and below the fixture arm.

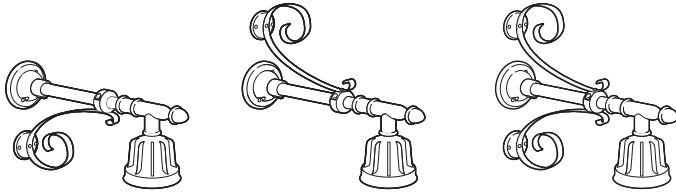

1. Remove both clamp assembly screws and one half of the split clamp.
2. Position Scroll Support assembly on fixture arm.
3. Reassemble clamp with two screws.
Clamp will be free to slide on fixture arm.

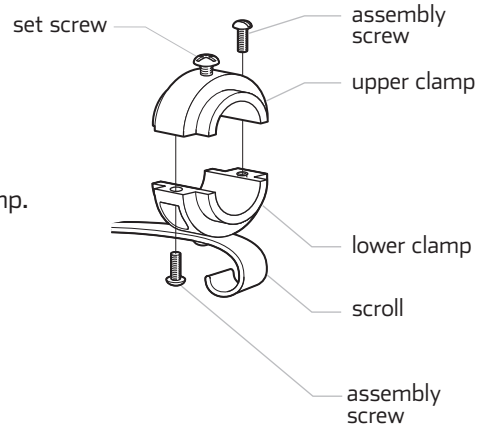

4. Slide Scroll Support assembly towards wall.
5. Using mounting plate as a template, mark two mounting holes.
6. Drill pilot holes for mounting screws.
7. Secure mounting plate with two screws

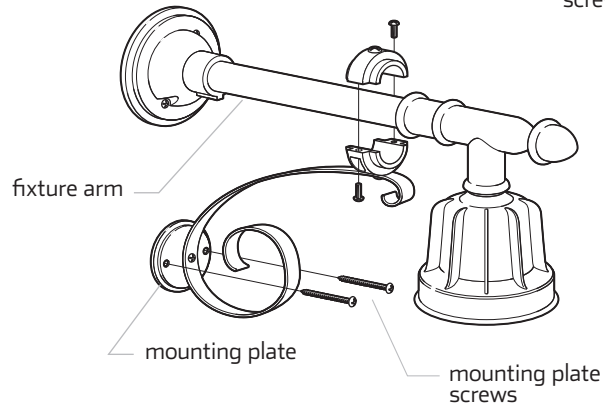

When attaching to a wall made of masonry material, lead anchors will be required.

If installing a single Scroll Support

8. Secure clamp onto fixture arm with set screw.

If installing double Scroll Supports

8. Repeat process for second Scroll Support.

Proceed with shade installation

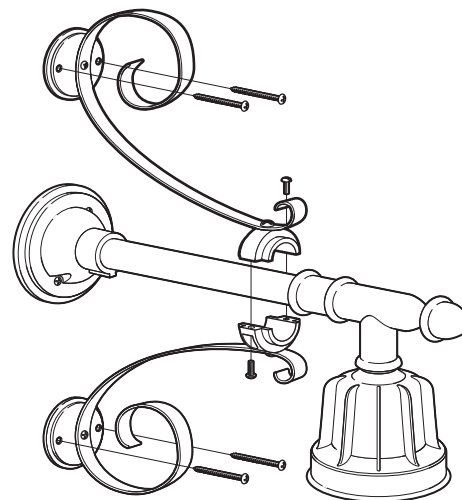

REJUVENATION®