

# Macadam Wall Wash Sconce & Flush Mount

skill level

• basic electrician

## installation instructions

*For a safe installation make sure that the electrical box is securely mounted to a structural member of the building.  
This fixture is suitable for damp locations.*

• toolbox

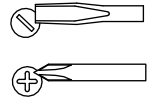

1. Attach crossbar to electrical box using screws supplied with the electrical box.  
These fixtures are supplied with a unique crossbar. This crossbar has curved slots to allow fixtures to be squared to the room, regardless of position of screw holes in the electrical box.
2. These fixtures can be installed in two different orientations that allow the screw heads of the fixture to be displayed. Mount crossbar in accordance with Figure A or Figure B for desired orientation
3. Make wiring connections in accordance with local electrical codes. Be sure to push wirenuts and connections inside the electrical box, as this fixture protrudes 1/4" into electrical box. See "Important Information" on reverse side.
4. Using all (x3) canopy screws and water sealing gaskets supplied (Phillips head) with the fixture, attach fixture to crossbar through holes in canopy sides. Be sure that fixture is aligned so that drain holes are orientated down.
5. Using the two top louver mounting screws supplied (flat head), fasten the top louver to fixture using the two threaded eyelets in the mounting brackets

Complete!

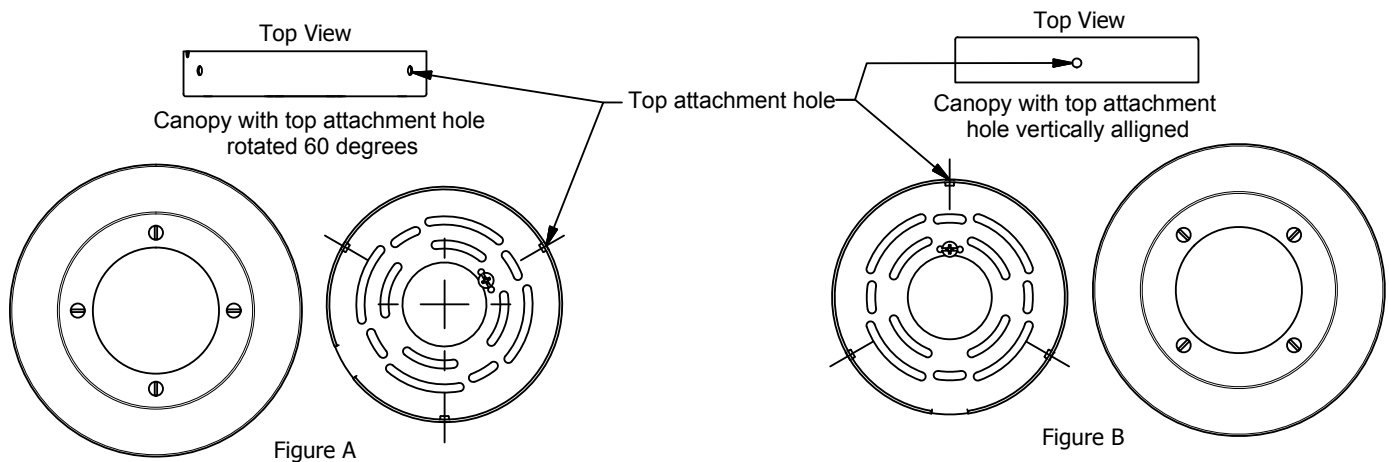
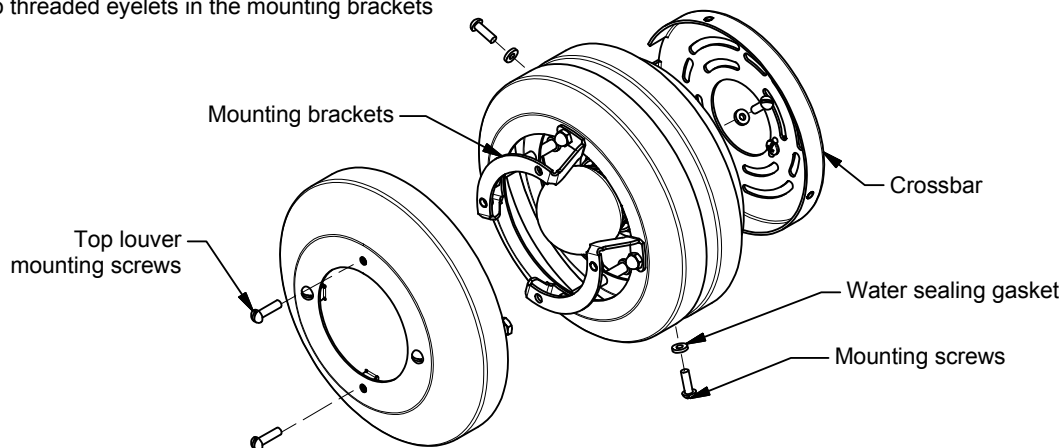

## REJUVENATION

2550 N.W. Nicolai Street, Portland Oregon 97210 Customer Service: 888-401-1900 rejuvenation.com