

Warehouse Wall Fixture

skill level • basic electrician

installation instructions

• toolbox



Fixture Installation

This fixture is designed to mount directly to a junction box, but in many installations use of the crossbar may be required to achieve a perfectly vertical alignment.

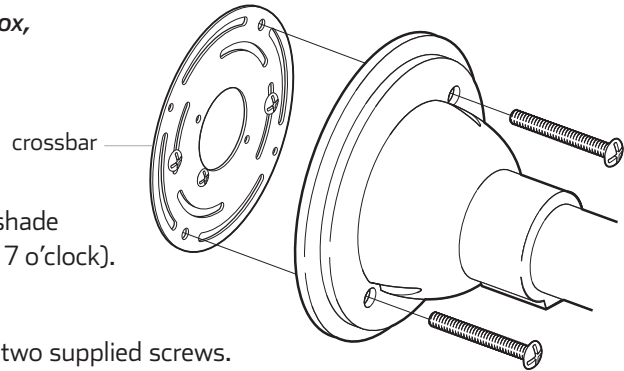

1. Mount the crossbar to the junction box, orienting the shade mounting holes at 45° diagonal (roughly 2 o'clock and 7 o'clock).
2. To achieve perfect alignment, do a test installation. Prior to wiring, assemble fixture to crossbar using the two supplied screws. Check for alignment. If fixture requires rotation, remove it, loosen crossbar screws and rotate crossbar as needed. Repeat test installation and crossbar adjustment until correct. After successful alignment, remove fixture from wall and tightly secure crossbar.
3. Holding the fixture close to the electrical box, connect the fixture wires to the house wires. Make connections as appropriate for your house wiring. See **Important Information** on reverse side.

4. This fixture is suitable for indoor or outdoor use. For wet locations, apply silicone sealant to perimeter of the back of the canopy where it meets the wall.
5. Secure the canopy to the junction box or crossbar using the two provided screws.

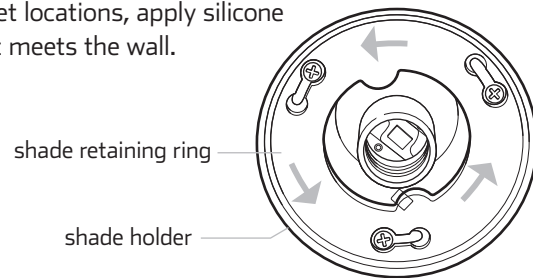

Install Optional Support Features

If purchased, refer to installation instructions provided with those components.

Shade Installation

6. Loosen three screws that secure the shade retaining ring and turn ring counter-clockwise until it can be slipped over the screw heads and removed.
7. Position shade onto the underside of the shade holder.
8. Place the retaining ring into the underside of the shade and locate slotted holes over three screws.
9. Rotate ring clockwise until the screw heads capture the ring.
10. Secure ring by tightening the three screws.

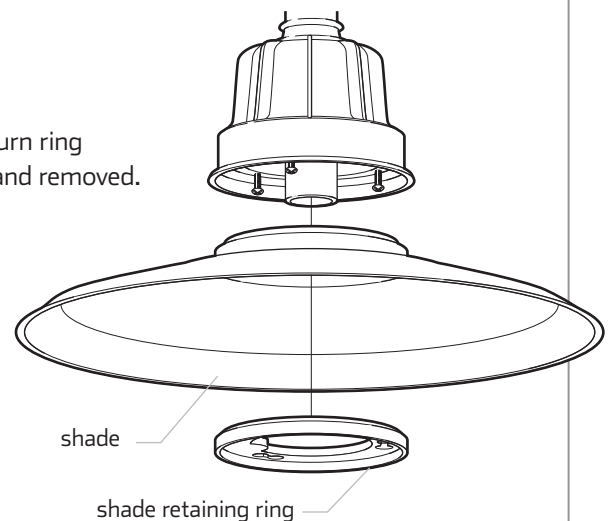

REJUVENATION®

2550 N.W. Nicolai Street, Portland Oregon 97210 Customer Service: 888 401-1900 rejuvenation.com

Warehouse Fixtures - Scroll Support

skill level • basic electrician

installation instructions

• toolbox



Scroll Supports can be used above, below or both above and below the fixture arm.

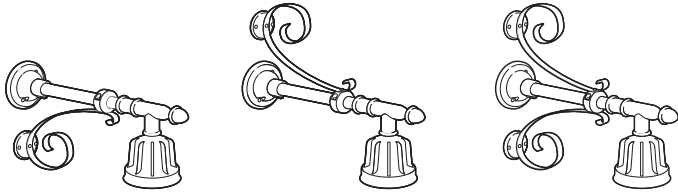

1. Remove both clamp assembly screws and one half of the split clamp.
2. Position Scroll Support assembly on fixture arm.
3. Reassemble clamp with two screws.
Clamp will be free to slide on fixture arm.
4. Slide Scroll Support assembly towards wall.
5. Using mounting plate as a template, mark two mounting holes.
6. Drill pilot holes for mounting screws.
7. Secure mounting plate with two screws

When attaching to a wall made of masonry material, lead anchors will be required.

If installing a single Scroll Support

8. Secure clamp onto fixture arm with set screw.

If installing double Scroll Supports

8. Repeat process for second Scroll Support.

Proceed with shade installation

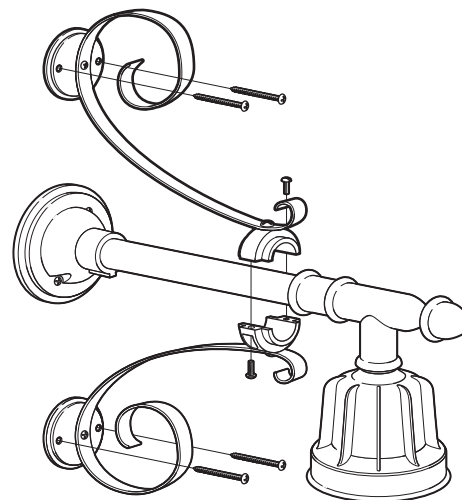
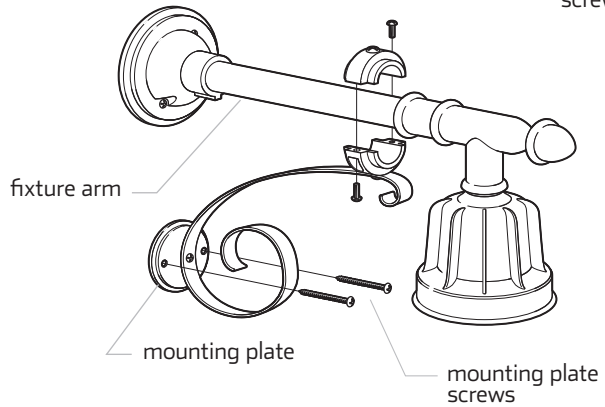
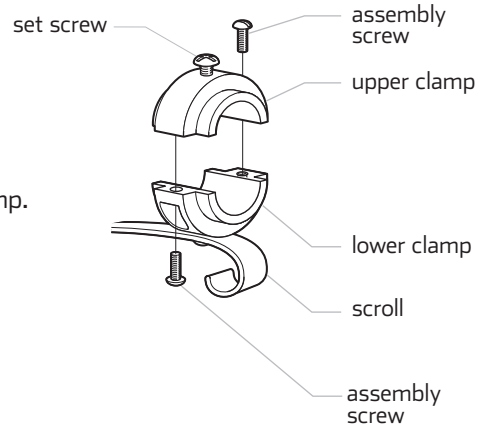

REJUVENATION®

Warehouse Fixtures - Chain Support

skill level • basic electrician

installation instructions

• toolbox



Chain Supports are available in single and double versions.

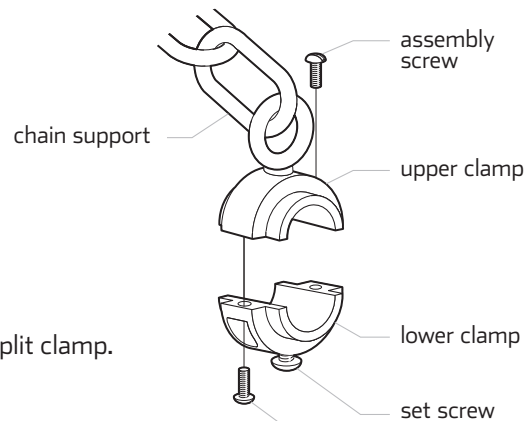
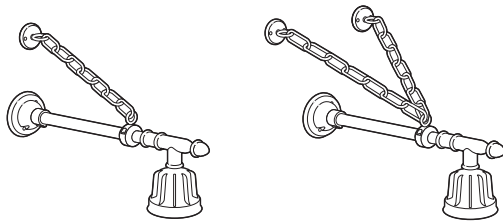

1. Remove both clamp assembly screws and one half of the split clamp.

2. Position Chain Support assembly on fixture arm.

3. Reassemble clamp onto fixture arm with two screws. Clamp will be free to slide on fixture arm.

4. At the same time, position clamp on fixture arm and mounting plate/s on wall to achieve desired Chain Support angle.

5. Using mounting plate as a template, mark mounting holes.

6. Drill pilot holes for mounting screws.

7. Secure mounting plate/s with two screws each.

When attaching to a wall made of masonry material, lead anchors will be required.

8. Secure clamp onto fixture arm with set screw on underside of clamp.

Proceed with shade installation

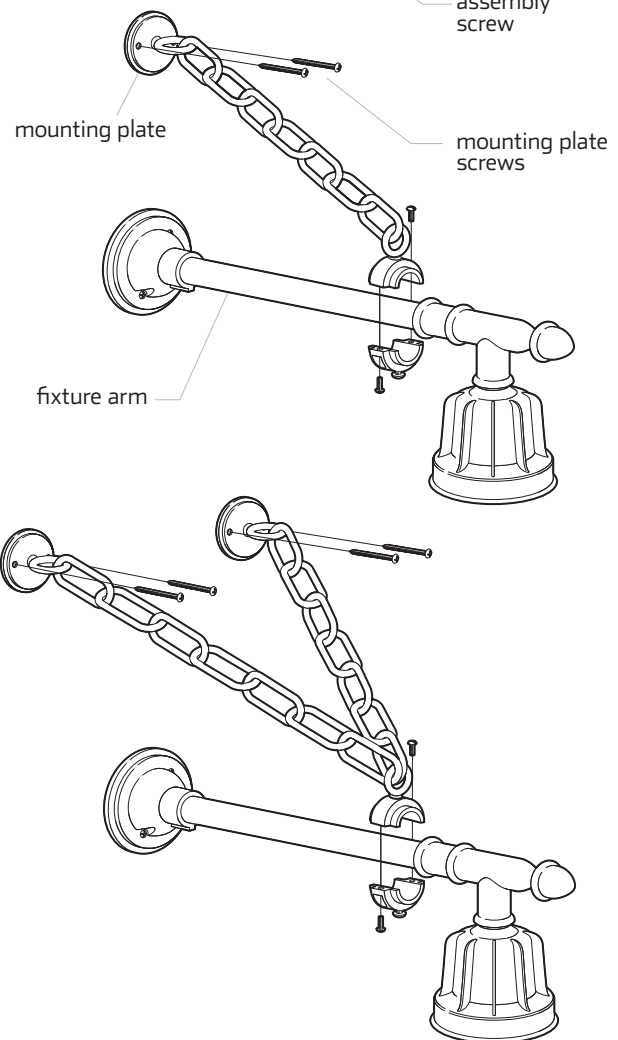

REJUVENATION®

Warehouse Fixtures - Rod Support

skill level • basic electrician

• toolbox



installation instructions

Rod Supports may be installed above or below the fixture arm.

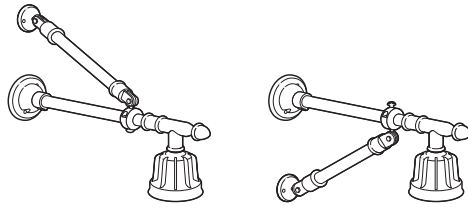

1. Remove both clamp assembly screws and one half of the split clamp.
2. Position Scroll Support assembly on fixture arm.
3. Reassemble clamp with two screws.
Clamp will be free to slide on fixture arm.
4. Position clamp on fixture arm and mounting plate on wall at the same time to achieve desired Support angle.

*Rod Support is designed to be installed at 45° angle.
Other positions may be incompatible with some shade options.*

5. Using mounting plate as a template, mark two mounting holes.
6. Drill pilot holes for mounting screws.
7. Secure mounting plate with two screws

When attaching to a wall made of masonry material, lead anchors will be required.

8. Secure clamp onto fixture arm with set screw.

Proceed with shade installation

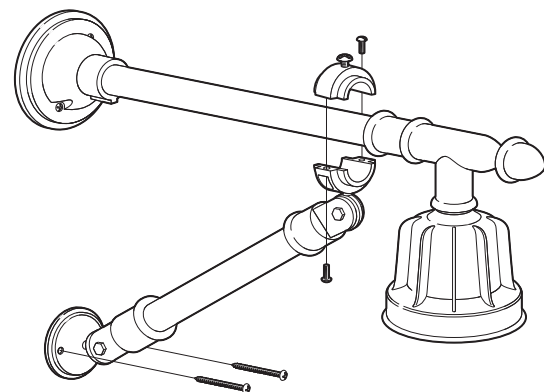
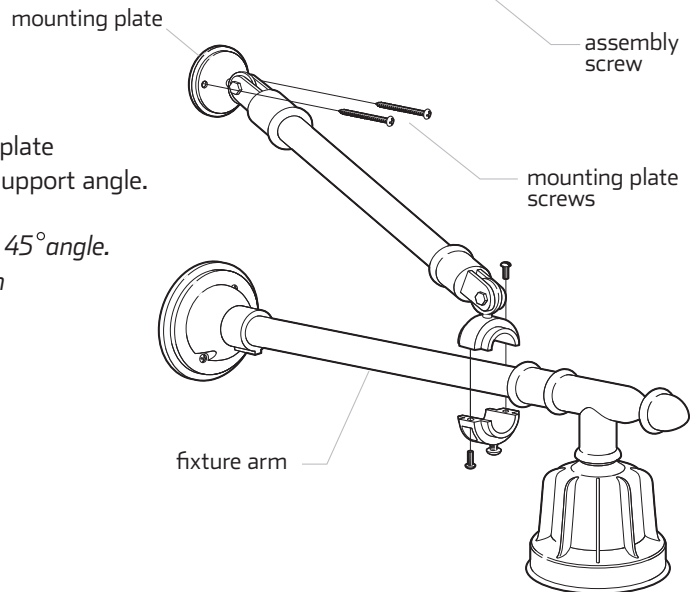
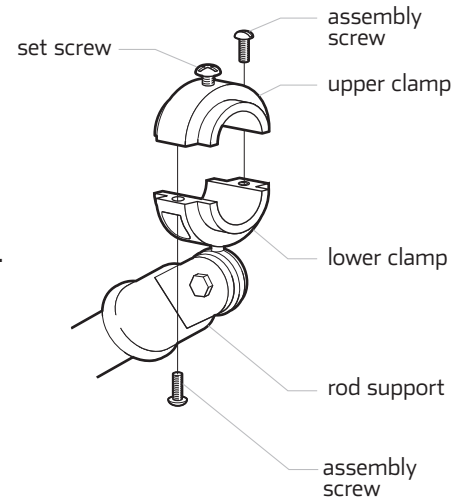

REJUVENATION®